

Demontage en montage glas

Let op dat bij het terugplaatsen van het glas, de ondersteuningsblokjes (2 verschillende) terug geplaatst worden op de juiste plek. Kijk op de volgende pagina's waar dit moet.

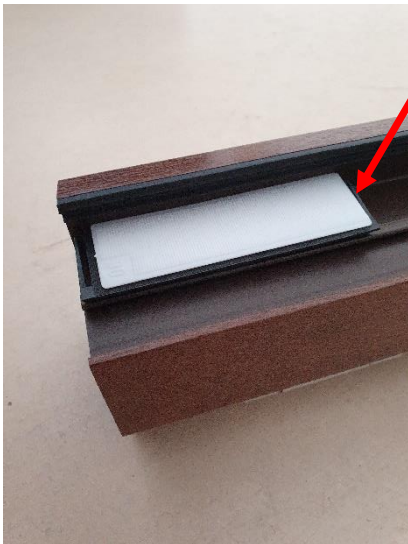

Onder het glas zitten ondersteuningsblokjes met vulplaatjes.



Let op dat je deze terug plaatst zoals je ze aangetroffen hebt.

Glazing / Blocking

Glazing can be carried out as glazing with sealed profiles under contact pressure (pressure glazing) or as glazing with sealing on both sides on to an adhesive strip.

DIN 18361 „Glazing Works“ and DIN 18545 „Sealing of Glazing with Sealants“ Parts 1 - 3 are the applicable glazing standards.

The working instructions and guidelines of insulating glass or sealant manufacturers, and the specifications of the VOB (Building Services Contracts Procedure) and of the Glazing Trades` Institute for Glazing Technology and Window Construction in Hadamar, are to be complied with.

When glazing with materials other than glass (e.g. Plexiglass PMMA, Polycarbonate) with co-extruded GA-glazing beads (Glasleisten), this can lead to the glazing material becoming brittle in the area of direct contact with the sealing lip. Through migration of the plasticizer. If such material is to be used, its compatibility should be checked with the supplier of the glazing material.

If glazing is done in the factory the glass must be made safe against slipping in transit with additional supporting blocks.

If glazing is undertaken on site, then glazing work can only commence after the window-frames are fully installed.

For blocking special plastic profiles are to be used. In special cases waste strips made from PVC plastic plates, which are equivalent to the blocking profiles, can also be used. In the case of balcony doors and entrance doors we recommend insertion of additional distance blocks in the central area of the upright profiles.

Support and distance blocks should be 2 mm thicker than the pane thickness. They must be prevented from shifting by adhesive or sealant.

The supporting blocks support the pane in the frame and should fill up precisely the space between pane and blocking bridge. The distance blocks are pushed in loose.

The correct position for the support and the distance blocks is to be adhered to (see blocking guidelines). Latter dropping down of the casement is often attributable to faulty blocking work.

In the case of heavy sound-proofing panes, corner brackets for distribution of load from the pane should be inserted in the glass groove. The cutting size for glazing must be increased about 2 mm, in the case of using the glazing bead GE 44 in combination with support block GK 738.

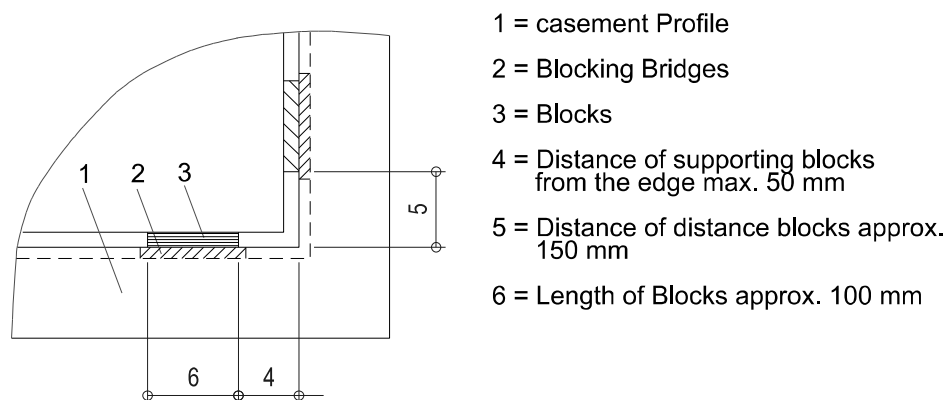

Blocking Guidelines

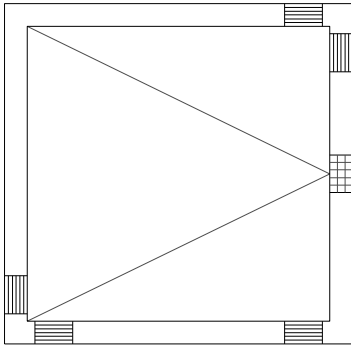

Side hung window

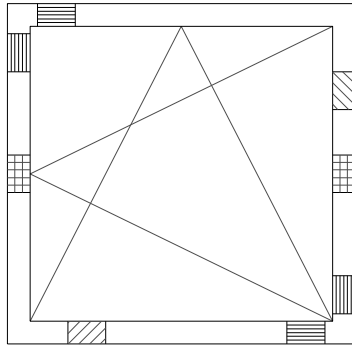

Tilt and turn window

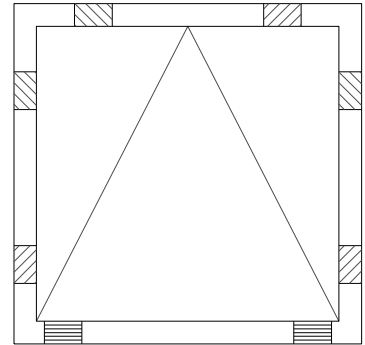

Bottom hung window

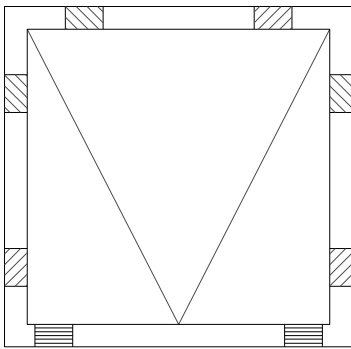

Top hung window

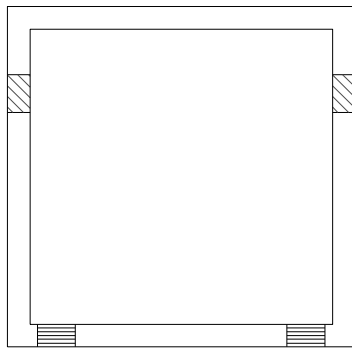

Fixed glazing

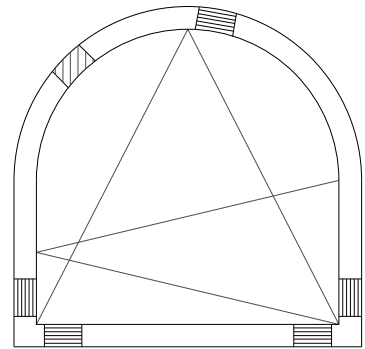

Tilt and turn window

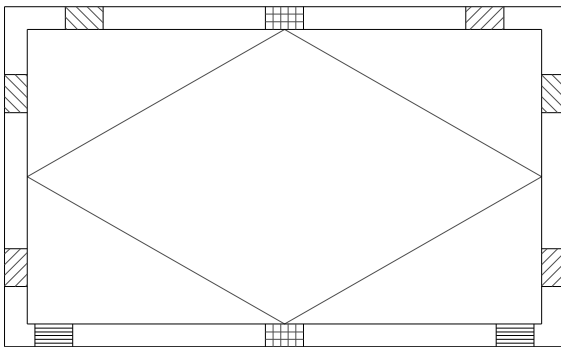

Pivot window

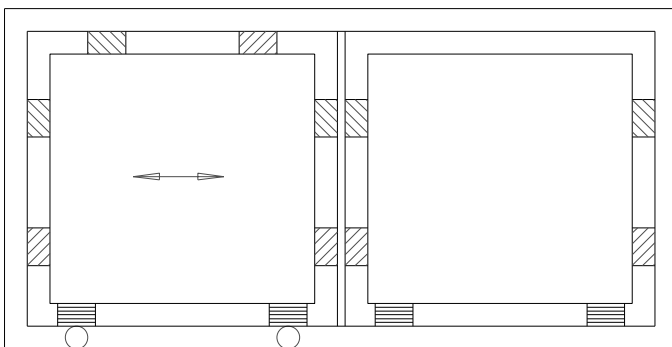

Lift- and slide door

 Supporting block

 Distance block

 Distance block
additionally from a profile length

ZA 780/D, ZA 780/FD,
ZA710/D, ZA 710/FD = 1.5 m

ZA 715/FD, ZA 720/D,
TSA 715/FD = 1.8 m

Blocking guidelines for cross bars

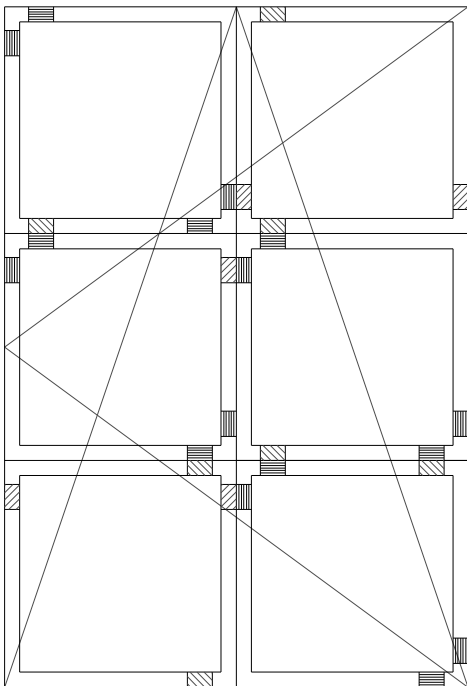
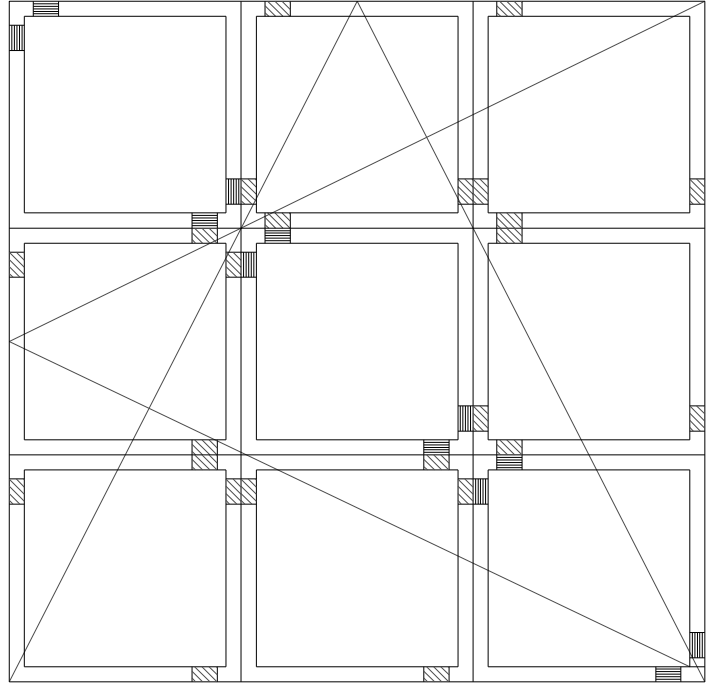
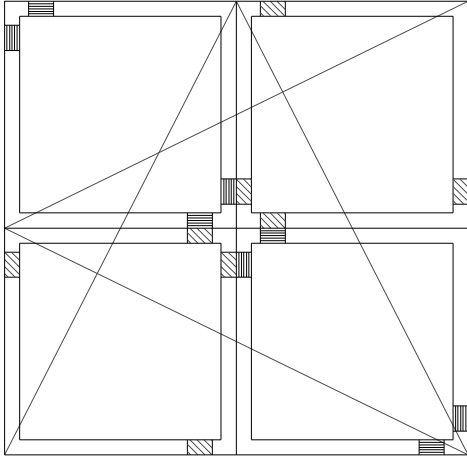

Blocking guidelines for Front doors

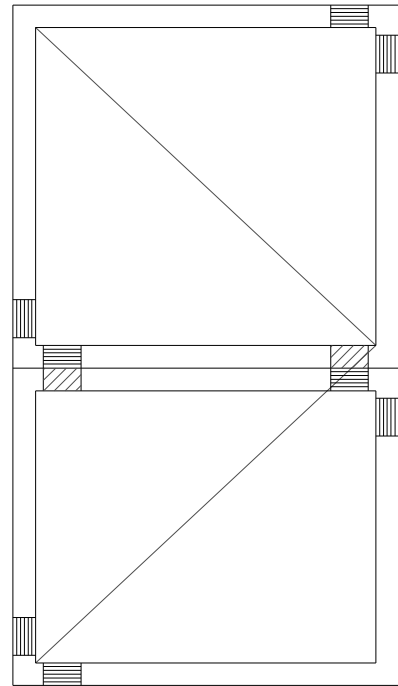
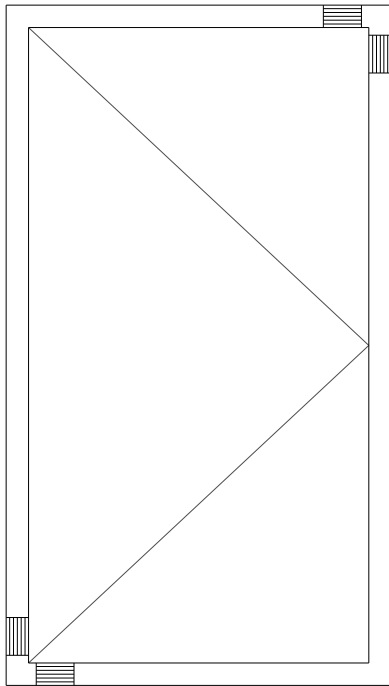

 supporting block

 distance block

Pressure Glazing

All sealing profiles for pressure glazing are manufactured from plasticizer-free, peroxide networked APTK / EPDM - material.

The glazing profiles are selected according to glazing tables, so that a pane edge load of 50 N per linear cm of pane length is not exceeded and a minimum corner pressure of 9 N per linear cm is achieved.

Working Hints

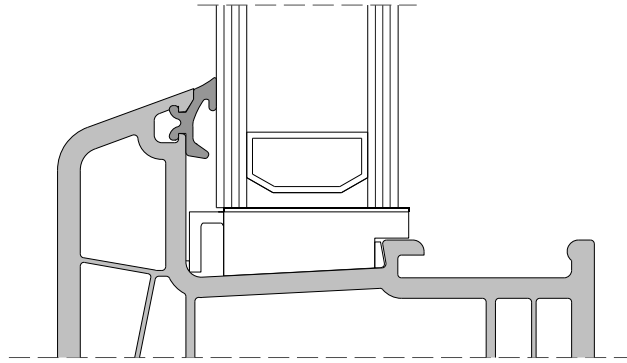

All sealing profiles should be tightened in rotation
TPE gaskets are welded in the corners.

Insert and block the pane. (Follow blocking guidelines)

Glazing beads

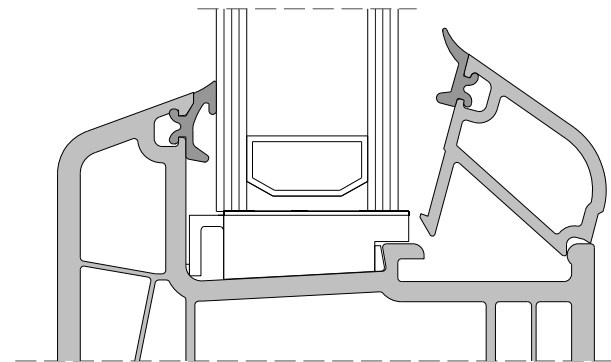

Cut glazing beads to miter. If necessary,
push the gasket into the glazing bead

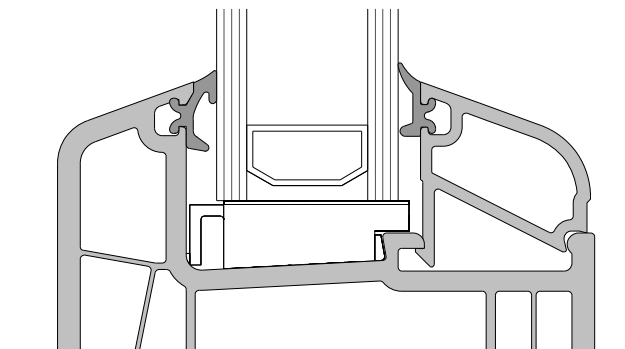

Clip in the glazing bead

For repair glazing you have the possibility to remove the glazing bead with a 20 mm knife between the main profile and the bead.

Glazing instruction for Inoutic PVC windows

1

01 / Assembling glazing beads with rectangular inner foot

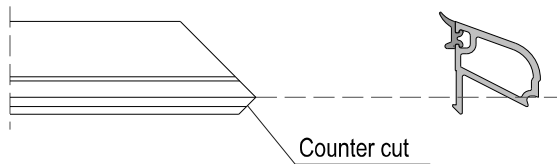

01 / 01
Make a miter cut on the glazing beads
and a counter cut at the foot.
No additional milling needed.

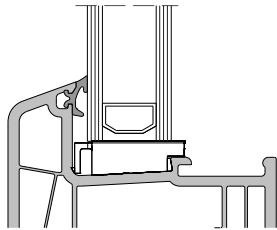

01 / 02
Insert glass pane, push it against
the gasket and block it

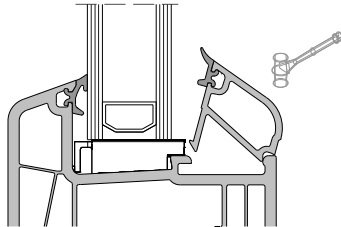

01 / 03
First insert the two shorter beads and drive
them in position with light soft head hammer beats.
Start at the non blocked end for a easy and light
hammering.

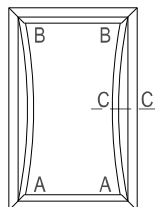
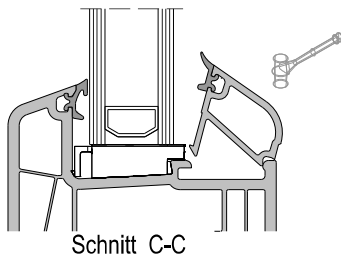

01 / 04
Insert the longer beads first at the bottom (A)
as described in 01/03, then bend the bead to
arch and adopt it under a ca. 45° angle in the
top corner (B). Fix the beads with a soft head
hammer.